



STANDARD PROPULSION

Mercury® 200 FourStroke Outboard
(200 hp / 149 kW)



FUEL CAPACITY

63 gal / 238 L



LENGTH OVERALL

25'2" / 7.67 m
with integral / extended swim platform



LENGTH OVERALL

27'6" / 8.38 m
with outboard engine



BEAM

8'6" / 2.59 m



DRAFT

36" / 91 cm (outboard down)



DRY WEIGHT

5,557 lb / 2,521 kg



DEADRISE

21°



WATER CAPACITY

10 gal / 38 L (opt)



CAPACITY

14 people / 2,300 lb / 1,043 kg
Maximum: 2,500 lb / 1,134 kg

FEATURES

- The intuitive helm is available with an optional 9" or 12" Simrad® touchscreen display to enhance the command experience.
- Premium Fusion® audio system with Bluetooth®, Wi-Fi audio streaming with Apple AirPlay® 2 & Digital Signal Processing (DSP).
- Interior head compartment with optional upgrade.
- Large bow & cockpit lounging floorplan with multiple convertible backrests.
- Optional Elite and Elite Plus packages available.

EXTERIOR COLORS

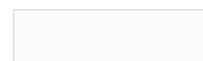

ARCTIC WHITE



ONYX BLACK



HORIZON



SEA RAY BLUE



QUANTUM BLUE



KINGFISHER TEAL

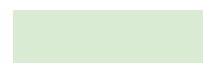

NEO MINT GREEN



RALLY RED



BLACK METALLIC



BLUE METALLIC

STANDARD FEATURES

HULL & DECK FEATURES

- Bow & Stern Eyes, Stainless Steel
- Bow Locker: Integral Fiberglass Hatch with Stainless Steel Hardware; Concealed Four Step Bow Boarding Ladder & Anchor Storage – Foredeck
- Cleats, Thru-Bolted (6), 6" Stainless Steel
- Deck, Fuel Fill Plate – Stainless Steel
- Drain Plug, Brass-Threaded – Garboard
- Gel Coat, Arctic White
- Hardware, Stainless Steel
- Lights, Navigation – Stainless Steel
- Rub Rail, White PVC with Stainless Steel Insert
- Swim Platform with Undermount Stainless Steel Three-Step Swim Ladder
- Windshield, Black Matte Finish with Port Walk-Thru to Bow

COCKPIT FEATURES

- Beverage Holders, Stainless Steel with Rubber Inserts
- Cockpit Vinyl Color: Ivory (White Base Vinyl with Brown Accent Vinyl)
- Cooler, Carry-On with Designated Storage
- Dash, Custom Upholstered Visor
- Door, Bow Block-Off – White Acrylic
- Door, Transom, Acrylic
- Floor, Finished Fiberglass
- Grab Handles, Stainless Steel
- Head Compartment: Enclosed with Fiberglass Lockable Door & Portable Head
- Lighting, Courtesy, White LED
- Outlet, 12V Accessory / USB
- Storage, Cockpit Floor with Vinyl Matting, Gas-Assisted Fiberglass Lid & Lockable Stainless Steel Latch
- Table, Cockpit with Designated Storage – Plastic
- Vinyl, Marine-Grade with Mildew & UV Protection

SEATING

- Bow with Aft and Forward-Facing Seating
- Double Helm Seat with Reversible Backrest, Flip-Up Thigh Rise & Fiberglass Base
- Double Port Companion Seat with Reversible Backrest, Flip-Up Thigh Rise & Fiberglass Base
- Port L-Shaped Lounger & Storage
- Sliding Transom Sunpad with Reversible Backrest & In-Floor Storage

TECHNICAL FEATURES

HELM

- Alarms, Engine – Oil & Water (Audible)
- Horn
- Instrumentation, Custom Sea Ray® SmartCraft® Diagnostics
 - Bezels, Chrome
 - Gauge, Fuel
 - Gauge, Trim
 - Lenses, Glass
 - Lighting, Low-Glare – Blue
 - Speedometer
 - System Tachometer with Digital Monitoring for Depth, Engine Alarms/Hours, Fuel Consumption/Usage, Oil Pressure, Trim Level & Voltage
- Mercury VesselView® Mobile
- SmartCraft Digital Throttle & Shift (DTS) with Trim Switch & Ignition Cutout Switch
 - Active Trim speed-based automatic engine trim system with integrated GPS
 - Engine Start / Stop
- Steering, Power-Assisted Tilt Wheel
- Stereo, Fusion® SRX400 12V AM/FM
 - Bluetooth™
 - Digital Signal Processing (DSP)
 - Speakers (6.5") – 2 Pairs
 - Wi-Fi Audio Streaming with Apple AirPlay® 2
- Switch Panel with Weatherproof Lighted Chrome Toggle Switches, Backlit
- Tilt & Trim, Power

BILGE COMPARTMENT

- Bilge Pump, 1100 GPH 12V Automatic
- Gel-Coated Compartment

ELECTRICAL SYSTEMS

- Battery On/Off Switch, Dual with 2 Trays
- Fuse Block
- Wiring, Color-Coded with Chafe Protection

FUEL SYSTEMS

- Evaporative Emissions Fuel System
- Fuel Lines, USCG – Type A-1
- Fuel Tank with Mechanical Anti-Siphon Valve & Electric Sending Unit

UNDERWATER GEAR

- Propellers, Stainless Steel

OPTIONS & ACCESSORIES

OPTIONAL PROPULSION

- Mercury 200 FourStroke Outboard – White (200 hp / 149 kW)
- Mercury 250 Verado® Outboard – Black (250 hp / 186 kW)
- Mercury 250 Verado Outboard – White (250 hp / 186 kW)
- Mercury 300 Verado Outboard – Black (300 hp / 224 kW)
- Mercury 300 Verado Outboard – White (300 hp / 224 kW)

EXTERIOR COLOR

- Gel Coat, Full Hull (Non-Metallic Gels Only)
- Gel Coat, Hull Bottom – Arctic White or Onyx Black
- Gel Coat, Hull Side
- Gel Coat, Three Zone (Metallic Gels Available for Zone 2 or 3 Only)

UPHOLSTERY, INTERIOR, SEATING & FLOORING

- Bow Filler Cushion
- Cockpit Table, Teak, with Dedicated Storage
- Cockpit Vinyl Color – Dune (Tan Base Vinyl with Brown Accent Vinyl)
- Cockpit Vinyl Color – Stone (Gray Base Vinyl with Dark Gray Accent Vinyl)
- Flooring Color: Brown or Gray

- Head Upgrade with Ventilation Window & Cushions
- SeaDek Flooring – Bow & Cockpit
- SeaDek Swim Platform Matting (Glue Down)
- Snap-In Infinity Woven Vinyl Flooring – Bow & Cockpit
- Table, Plastic – Bow with Dedicated Storage

TOWERS & CANVAS

- Bimini Top & Boot with Stainless Steel Ball & Socket Hardware
- Canvas Color: Black or Marine Midnight Blue
- Canvas Package For Bimini Top
 - Cockpit and tonneau cover
 - Front visor with isinglass
 - Side curtains with isinglass
 - Aft curtain with isinglass
 - Storage bag
- Cockpit Cover with Tonneau Cover
- Full Forward Bimini Top & Boot (N/A with Optional Tower)
- Mooring Cover – Available in Black Only
- Watersports Tower, Manual with Integrated Bimini Top – Black or White

ELECTRONICS

- Audio Upgrade, Premier – Fusion® Apollo RA770 12V AM/FM
 - NRX 300 Transom Remote
 - Signature Series 5-Channel Amplifier (1600W)
 - Signature Series Speakers (6.5") – 3 Pairs
 - Signature Series Subwoofer (10")
- Digital Dash (9") with Mercury® VesselView® Link
 - Active Trim control & monitoring
 - Chartplotter with Preloaded Charts (North America Only)
 - Simrad® G09 (9") Touchscreen Display
 - Transducer with Depth, Water Temperature and Fishfinder
- Digital Dash (12") with Mercury® VesselView® Link
 - Active Trim control & monitoring
 - Chartplotter with Preloaded Charts (North America Only)
 - Simrad® G012 (12") Touchscreen Display
 - Transducer with Depth, Water Temperature and Fishfinder

ADDITIONAL OPTIONS

- Air Compressor for Water Toys
- Bow & Transom Sprayer
- C E Option Group
- Docking Lights
- Fender Clips (6) – Quick Connect
- Flagpole with Base & US Flag
- Lighting, Underwater (Thru-Hull) – Blue or White
- Lighting Package, LED – Blue or White
- On Board Battery Charger – 120v/60 To 12v
- On Board Battery Charger – 220v/50 To 12v
- Premium PTM Ski Mirror
- Pump-Out Head
- Swivel Wakeboard Racks
- Tower Accent Panels
- Tower Speakers (Includes 2 Fusion[®] 8.8" Signature Series Can Speakers & 1400W Amp) (Only Available with Tower & Stereo Upgrade Options)

TRAILER OPTIONS

- Trailer, Tandem Axle with Tandem Axle Disc Brakes (Galvanized)
- Trailer, Tandem Axle with Tandem Axle Disc Brakes (Painted)

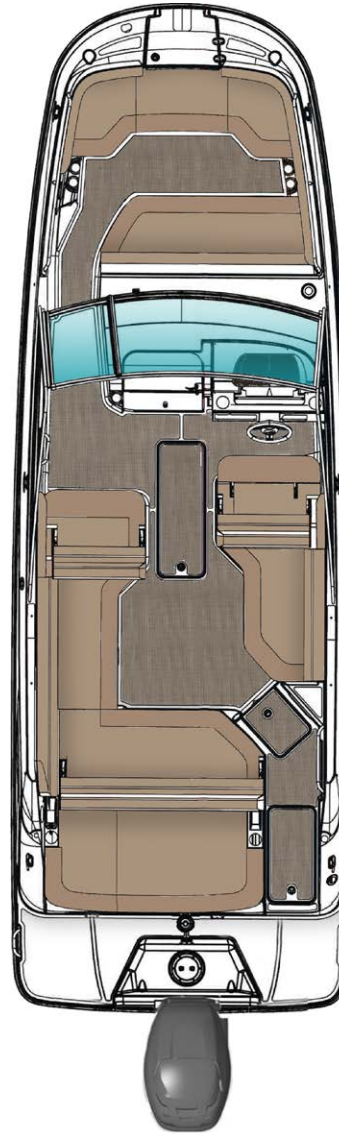

STANDARD SEATING PLAN

2022 PACKAGES

SDX SERIES



	SDX 250	SDX 250 OB	SDX 270	SDX 270 OB	SDX 290	SDX 290 OB
Digital Dash™ (9") with Mercury® VesselView® Link	✓	✓	✓	✓	✓	Standard
Fender clips	✓	✓	✓	✓	✓	✓
Lighting package, LED	✓	✓	✓	✓	✓	✓
SeaDek® on swim platform	✓	✓	✓	✓	✓	✓
Swim platform with manual submersible step	✓		✓		✓	
Watersports tower with Bimini top	✓	✓	✓	✓	✓	✓



	SDX 250	SDX 250 OB	SDX 270	SDX 270 OB	SDX 290	SDX 290 OB
Elite Package included	✓	✓	✓	✓	✓	✓
Anchor, stainless steel (only with windlass)			✓	✓	✓	✓
Cushion, bow filler	✓	✓	✓	✓	✓	✓
Digital Dash™ (12") w/ Mercury® VesselView® Link	✓	✓	✓	✓	✓	✓
Head (interior upgrade)	✓	✓	✓	✓	✓	✓
Lighting, underwater (thru-hull)	✓	✓	✓	✓	✓	✓
Stereo upgrade, premier (spkr/subwoofer/amp)	✓	✓	✓	✓	✓	✓
Table, cockpit – teak	✓	✓	✓	✓	✓	✓
Windlass (rope/chain with galvanized anchor)			✓	✓	✓	✓